

BEST LOCATION IN GREATER NOIDA WEST

- 5 Min. Drive to Noida
- 10 Min Drive to Ghaziabad
- 20 Min Drive to DND

SP SAI IT Pvt. Ltd.

Corporate office: Plot No -17, Tech Zone – IV, Greater Noida (West), U.P.

Site Office: Plot No -17, Tech Zone – IV, Greater Noida (West), U.P.

Sales No.: +91-97 181 30000, Ph. No.: 0120-5185888

E-mail: info@nx-one.com, sales@nx-one.com, Web.: www.nx-one.com

RERA Registered No.: UPRERAPRJ4746

Scan me for location



BYTE
HI-TECH BUSINESS
PARK & OFFICES





NX STUDIOS
(Corporate Suites - T2)

SIGNATURE TOWER
(Offices)

NX AVENUE
(Residence)

NX BYTE - T3
(Offices)

NX ONE
TRADE CENTRE / T1
(Offices)

NX BYTE - T4
(Offices)

NX ONE
MALL

CLUB
HOUSE

INCREDIBLE NX ONE

- CONSTRUCTION STAGE AHEAD OF PROMISED TIME
- METRO 400 MTR.
- SHOPPING MALL
- JOGGING TRACK
- GYMNASIUM
- DAY CARE
- UTILITY ANCHOR STORE
- INDOOR GAME ROOM
- GRIHA REGISTERED GREEN BUILDINGS
- EARTHQUAKE RESISTANT
- YOGA
- SWIMMING POOL
- HI-SPEED LIFT
- CHILDREN'S PLAY AREA
- GATED COMMUNITY
- FULLY PAID UP LAND
- RERA COMPLIANT PROJECT
- 24 x 7 POWER BACKUP
- CLUB HOUSE
- RESTAURANT
- RAINWATER HARVEST
- SEWAGE TREATMENT
- FIRE EXTINGUISHER

OUR ESTEEMED BRAND PARTNERS



OUR BANKING PARTNER



All specifications, designs, layout, images, conditions are only indicative and some of these can be changed at the discretion of the builder/architect/authority. These are purely conceptual and constitute no legal offerings. 1sqm = 10,764 sq. ft.



30 M WIDE ROAD
CONNECTING TO NOIDA GR. NOIDA LINK ROAD

28 M WIDE ROAD
CONNECTING TO NOIDA GR. NOIDA LINK ROAD



Power-packed Conveniences

LOCATION

- 400 mtr away from proposed metro station.
- Best location in Greater Noida west: Bang on Kisaan Chowk.
- 425 feet wide road on one side & 80 feet wide on the other.
- 2 sides open plot that ensures optimum light & ventilation.
- First and only Mixed Land use Township in Noida Extension.
- Excellent connectivity to Delhi, Noida, and Ghaziabad.

PROJECT

- ★★★★★ 4 Star Pre-Certified by GRIHA.
- 25 Acre Township: Offices, Residences and Shopping Mall.
- Construction ahead of promised time line.
- Fully paid up land.
- Approved Plans.
- Competitive Price.
- Customer friendly payment plans.

SPECIFICATIONS

- FLOORING** : R.C.C. slab top.
- WALL FINISH** : Side Cement plastered walls.
Front wall in toughened glass.
Rear wall with door in double glass unit with Aluminum frame.
- CEILING FINISH:** R.C.C. slab bottom.
- DOOR** : Toughened clear glass door with S.S. hardware.

CORRIDOR & COMMON AREA

- FLOORING** : Stone/Ceramic tiles.
- WALL FINISH** : Plaster with O.B.D. paint.
- CEILING** : Grid false ceiling.

FLOOR PLAN

Tower 3, 4

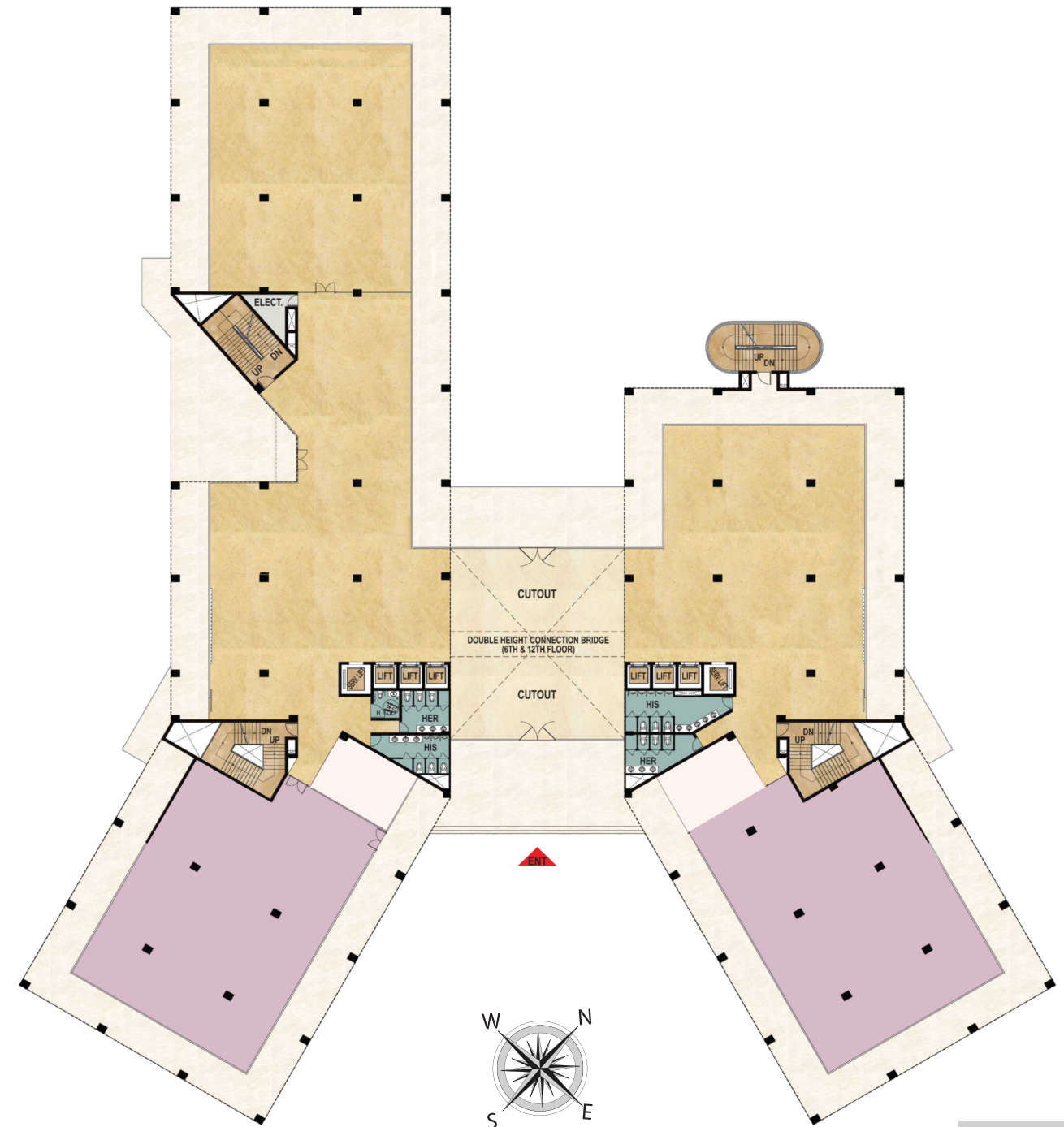



NX STUDIOS
(Corporate Suites - T2)

NX BYTE - T3
(Offices)

NX BYTE - T4
(Offices)

NX ONE MALL

SIGNATURE TOWER
(Offices)

NX ONE
TRADE CENTRE / T1
(Offices)

NX AVENUE
(Residence)

CLUB HOUSE